



FIRESTOP CENTRE

Authorised New Zealand Distributor
Ph (09) 483 4000 www.firestopcentre.co.nz

FIRESTOP Duct Wrap-38 Rectangular duct (up to 1800 x 1000mm) Plasterboard wall (1x13mm or 2x13mm) Internal or External Fire



Report FTSL AR23108, Pages 7, 16, 18
FAS AS1530.4-2014 AS4072.1-2005

System ID# FC107

INSTALLATION INSTRUCTIONS

- Aperture must be framed and lined to match the wall. Annular gap 10 - 30mm.
- Place unfoiled Firestop Duct Wrap material compressed nominally 30% into the annular gap with 20mm recess each side. Ensure any gaps in corners, etc are filled to the required compression.
- Seal each side of the wall with 20mm deep Protecta FR Acrylic Sealant.
- Attach 1.2mm thick steel angle 75mm x 75mm to all sides. Fix to the duct with steel rivets 10mm x 5mm diam at 100mm centres in the centre of the angle. Fix to the wall with plasterboard screws (min 40mm) at 200mm centres high enough to clear the annular space. Seal any joints or corner gaps with Protecta FR Acrylic Sealant.
- Construct a collar minimum 100mm high from Protecta FR Board (60mm 2-sided) and fix directly to the wall with 8-10g x 100mm screws with penny washers at 200mm centres (passing above the steel angle).
- Use Protecta FR Acrylic Sealant to fill any gaps in the collar. Then apply a 20mm fillet at the wall/collar joint and the duct/collar/angle joint. Finally cover the exposed cut edges of the collar with Protecta FR Acrylic or Protecta FR Coating.
- Install the Firestop Duct Wrap layers as specified and seal the wrap/collar junction with Protecta FR Acrylic.

NOTE: Diagram shows 2 layer system, but see details on right for number of layers

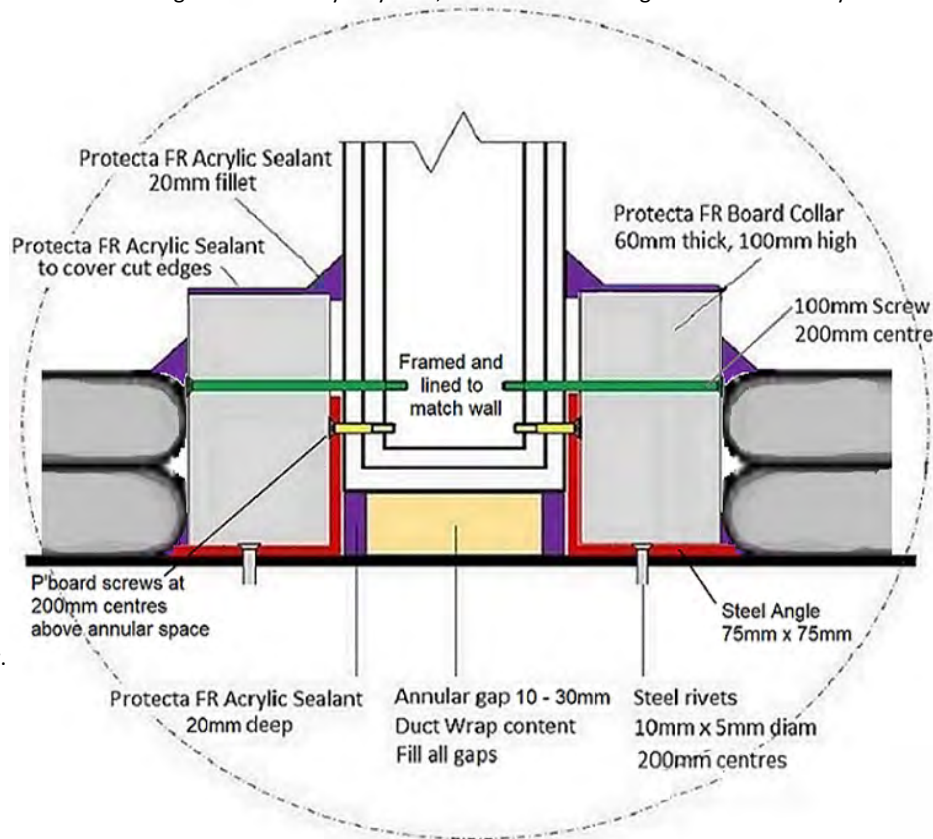

Products	FIRESTOP Duct Wrap-38 Protecta FR Board Protecta FR Acrylic
Application	Fire stopping of rectangular duct penetrating a plasterboard wall
Construction	Plasterboard wall min 90mm thick steel or timber stud with 1 or 2 layers of 13mm fireboard

Fire Classification

NOTE: For general instructions on installing FIRESTOP Duct Wrap-38 see [Installation Instructions](#) sheet on Firestop Centre website.

Internal Fire

For 1 x 13mm walls 60min:

Single layer wrap	FRR 60/60/30
Add 1400mm second layer	FRR 60/60/60

For 2 x 13mm walls 120min:

Single layer wrap	FRR 120/120/30
Add 1400mm second layer	FRR 120/120/60
Add 1900mm second layer	FRR 120/120/120

External Fire

For 1 x 13mm walls 60min:

Double layer wrap	FRR 60/60/60
-------------------	--------------

For 2 x 13mm walls 120mins:

Double layer wrap	FRR 120/120/120
-------------------	-----------------

As a part of our policy of on-going product development and testing, we reserve the right to modify, alter or change product specifications without giving notice. All information contained in this document is given in good faith and is provided for guidance only. Any drawings provided are for illustrative purposes only. As Firestop Centre has no control over the methods or competence of installation and of prevailing site conditions, no warranties, expressed or implied are intended to be given as to the actual performance of the product mentioned or referred to herein and no liability whatsoever will be accepted for any loss, damage or injury arising from the use of the information given.

For all technical details on the products specified please refer to the technical data sheets that can be found on www.firestopcentre.co.nz

Signed and approved:



Firestop Centre Ltd
657 Great South Road
Epsom, AUCKLAND

Sheet size:
A4

Drawn date & no:
20/5/24